

DISTANCE TO FINISH GRADE SHALL BE 1" IN TURF AREAS AND 1" PLANTING AREAS FOR A MINIMUM OF 8" FROM EDGE OF PAVING BEFORE TRANSITIONING TO DEPTH OF SPECIFIED BARK MULCH LAYER

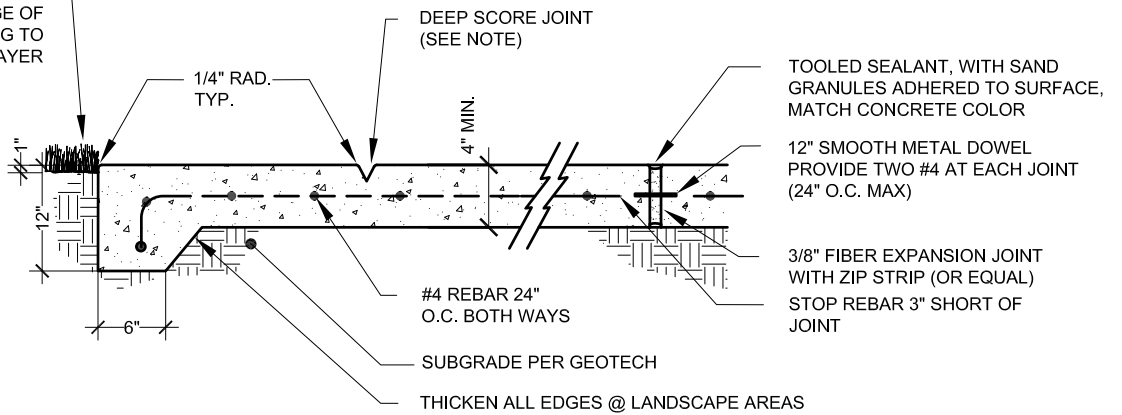

**NOTES:**

1. COMPRESSIVE STRENGTH - MIN. 3,000 PSI
2. FINISH TO BE MED. BROOM FINISH UNLESS OTHERWISE NOTED ON DRAWINGS
3. MIN. CROSS SLOPE ON ALL CONCRETE SURFACES TO BE 1%. MAXIMUM SLOPE 2% UNLESS NOTED OTHERWISE.
4. DEEP SCORE JOINTS TO BE 1/4 DEPTH OF TOTAL CONCRETE THICKNESS. SEE PLAN FOR SCORE JOINT AND EXPANSION JOINT SPACING