

DISTANCE TO FINISH GRADE SHALL BE 1" IN TURF AREAS AND 2" IN PLANTING AREAS

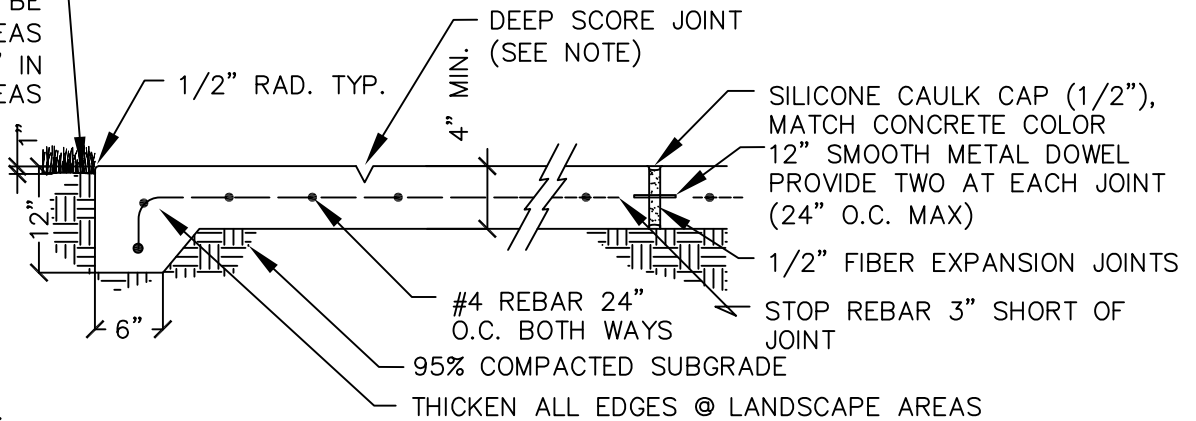

NOTES:

1. COMPRESSIVE STRENGTH – MIN. 3,000 PSI
2. FINISH TO BE MED. BROOM FINISH UNLESS OTHERWISE NOTED ON DRAWINGS
3. MIN. CROSS SLOPE ON ALL CONCRETE SURFACES TO BE 1%. MAXIMUM SLOPE 2% UNLESS NOTED OTHERWISE.
4. DEEP SCORE JOINTS TO BE 1/4 DEPTH OF TOTAL CONCRETE THICKNESS. SEE PLAN FOR SCORE JOINT AND EXPANSION JOINT SPACING



CONCRETE PAVING

NTS

UNIVERSITY OF CALIFORNIA, DAVIS		
CONCRETE PAVING		
REVISION: 1		
SCALE: NTS	DATE: JULY 11	
DWN:	APPROVED	FILE NO. H-02
CHK:		